

DIGITAL TOPOGRAPHICAL SURVEY BY TOTAL STATION FOR FEET
MAP OF RL

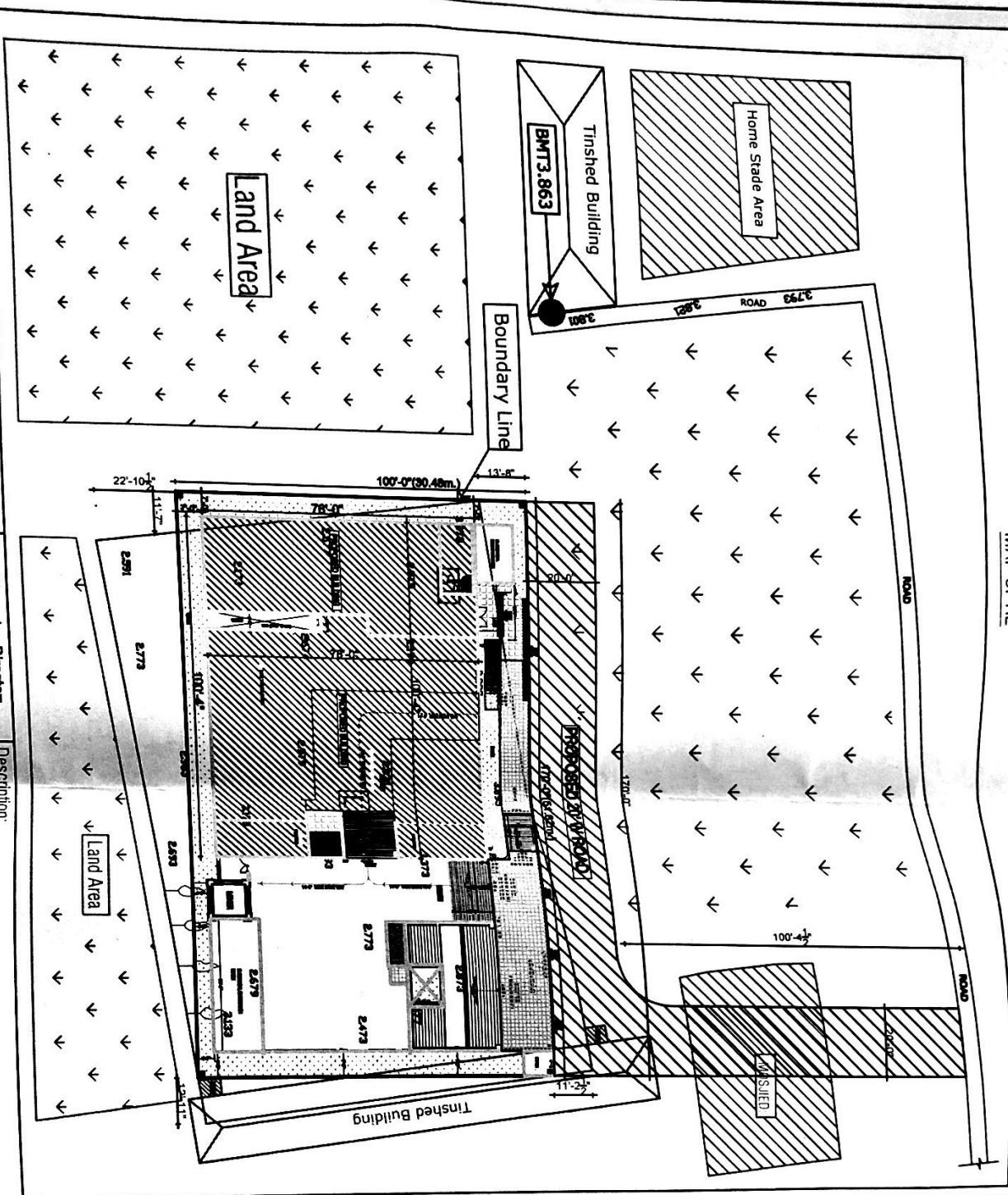

LEGEND

Building :	U.C Pucca Road
BOUNDARY :	TBM Point
ST :	MOSQUE
Trinshed Hut :	Home Stade Area
Tree :	Lowland :
Home :	Small Pucca :

Note:-
All dimension are in feet
TBM is considered at Building
plinth level (TBM RL-3.863 m)

Total Area

1741.36 sq meter
18737.08 sq feet
43.01 Decimal
26.02 Katha



CLIENT:

PWD (Borguna Zilla)

SUPERVED BY:

CONCRETE BUILDING
DESIGN AND
ENGINEERING LAB

RAZIA YOBON BOTOLA BAZAR
NOBODGRAM ROAD BARISHAL
web:www.concretehdl.com
CONTACT:01748856641

PROJECT NAME:
Digital Topographical Survey (Model Masjid)
Khasian no- , Dag no- , JI no- , Mouja-
Betsagi,Borguna

SURVEY BY:
Engr. Abu Naeem

Managing Director:
Engr. Shahadat Sofit

Description:
Reviewed By:
10-12-19
XSA, PWD

Drawing By: Abdullah Ali Mamin
Date of Survey: 17-07-2019
Scale: 1:500